

**All zinc-coated accessories are available also in stainless steel. In this case the type-figures must be extended by „-VA“.**

### Cable Glands

- KV-M25K** Cable gland M25x1,5 made of polyamide, with strain relief  
**KV-M25MS** Cable gland M25x1,5 made of nickeled brass  
**KV-M25Z** Cable gland M25x1,5 made of nickeled brass, with strain relief

### Pull Cord

- RL5** 5mm pull cord, 19-core zinc-coated steel cable 2mm diameter, red UV-stabilised PVC-coating gross 5mm diameter  
**RL3** 3mm pull cord, 19-core zinc-coated steel cable 2mm diameter, red UV-stabilised PVC-coating gross 3mm diameter  
 available in free lengths ( type RL5B or RL3B) or 500m on 1 drum (type RL5F or RL3F)

### Pretensioning Springs

- SPF-W** Pretensioning spring, for mounting within the line of the pullcord, with strain relief, for fulfilment of the standard EN 60947 as well as EN 620 (automatical actuation of the pull cord switch in case of a fracture within the pull cord) (2 items necessary per switch). Made of stainless steel.

### Turnbuckles (tensioner elements)

- SPS6** Turnbuckle for easy and fine adjustment of the length and the pretension of the pull cord (for right function not really necessary, but easier mounting is guaranteed) (1 eye of the turnbuckle for bolting direct into the operation lever of the DUK-pullcord switch, the other eye for connection with the pullcord), zinc-coated.

### Rope Thimbles

- SKA5** Rope thimble for the 5mm pull cord (not essential necessary), zinc-coated  
**SKA3** Rope thimble for the 3mm pull cord (not essential necessary), zinc-coated

### Rope Clips

- SKL5** Rope clip for the 5mm pull cord, zinc-coated  
**SKL3** Rope clip for the 3mm pull cord, zinc-coated

### Eyebolts, Rope Loops

- SH...** Rope loops for support of the pull cords in intervals not longer than 4m, available in different sizes as well as with open or closed loops, zinc-coated

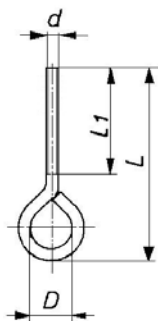

Rope loop closed

Typ	d	L	L1	D(mm)
<b>SH0</b>	M6	80	55	10
<b>SH2</b>	M10	130	85	14
<b>SH4</b>	M8	90	55	23
<b>SH5</b>	M12	100	55	17

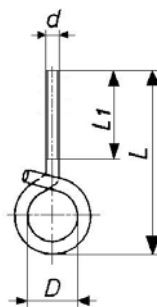

Rope loop open

Typ	d	L	L1	D(mm)
<b>SH1</b>	M8	70	25	27
<b>SH3</b>	M10	120	55	27
<b>SH6</b>	M12	180	60	27
<b>SH7</b>	M8	170	70	25